

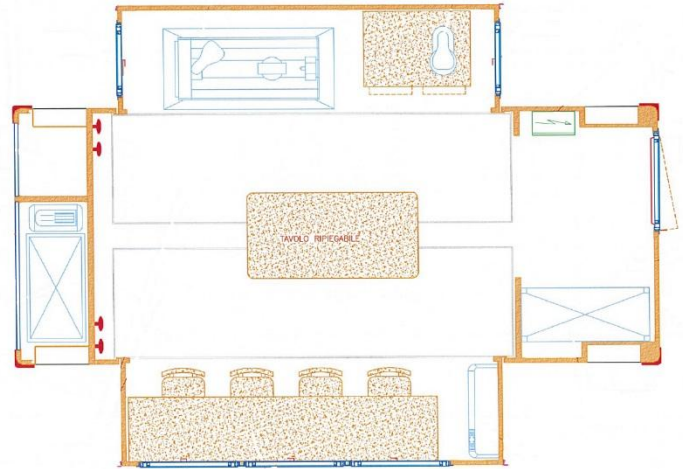

## DATA SHEET 24.6



Front view in operating position



Plan of the unit in the "open" operating position



Rear view with the extended symmetric sides and technical compartment

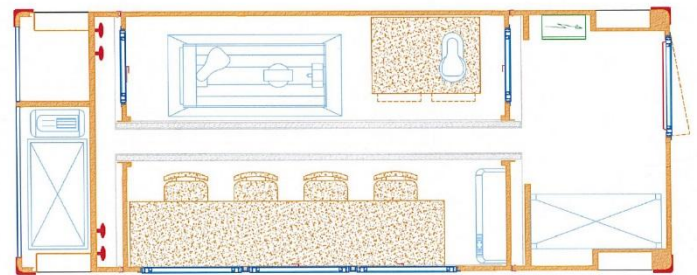

Plan of the unit when "closed" for transport

### Mobile workshop Shelter on expandable Iso 20ft Container

#### MOD. CON20-2GV-LAB-EV-10A

- |   |   |
|---|---|
| <ul style="list-style-type: none"> <li>a) Sturdy supporting structure with welded aluminium section bars with corner blocks as per ISO 20'-1CC standard and provisions for hydraulic system on the structure.</li> <li>b) Transportable by standard vehicles, as well as international standards (ship - train - container vehicles, etc.).</li> <li>c) Colored vinyl flooring, strongly glued and finished, mounted on waterproof multi-layer wood panels, with hinged movable elements for "expansion/closure" of the unit.</li> <li>d) Claddings in smooth insulated and perfectly sealed 40 mm panels in double aluminium 1 mm internal/external sheets.</li> <li>e) No. 4 cable outlets arranged in the outer wall for uses based on the needs.</li> <li>f) Removable sides from the main body, self load-bearing and equipped with systems and fittings.</li> <li>g) Door and window frames in aluminium with safety glass and panic bar on the door.</li> <li>h) Staff entrance at the front; three windows on the left side; two windows on the side wall of the removable body.</li> <li>i) Possibility to be used on board of the vehicle and set on the ground (<b>on request also "self-unloading"</b>)</li> <li>j) Rear technical, insulated and equipped compartments.</li> <li>k) Painting and finishing with custom features of easy identification.</li> <li>l) Size in "closure" position: length 6058 x width 2438 x height 2591 mm. (as per ISO 20'-1CC standard); overall dimensions in "operating" position: length 6058 x width 4284 x height 2591 mm.</li> <li>m) Set-up time for "ready state": about 1/2 hour, with trained staff.</li> </ul> | <ul style="list-style-type: none"> <li>1. Electrical power supply from 380 V (220 V on request) from external grid or generator.</li> <li>2. Internal electrical panels for external branches and safety devices in compliance with current regulations.</li> <li>3. System for internal/external lighting, sockets placed on the workstations and for the fitted apparatus.</li> <li>4. Module equipment with the following technical material: <ul style="list-style-type: none"> <li>&gt; n.1 workbench (dimensions: length 2800+3000 x width 600 x height 750 mm) fixed to the wall with rubber surface and drawers below;</li> <li>&gt; n.1 lathe with standard equipment (dimensions: 1600 x 750 x height 1250 mm, weight: Kg 520);</li> <li>&gt; n.1 pillar drill with drawer for specific equipment, fixed to steel bench;</li> <li>&gt; n. 4 five spokes-stools on adjustable feet with plastic or shaped wooden seat and backrest;</li> <li>&gt; n.1 cupboard in galvanized steel with 4 shelves, dimensions 1200x500 mm, fixed to the wall;</li> <li>&gt; folding work table with folding legs for the central area;</li> <li>&gt; mono-split heating and air conditioning system with remote control.</li> </ul> </li> <li>5. Compressed-air system with branch from compressor unit of about 50 litres;</li> <li>6. No. 1 sound-proof generator of 5 or 10 KW, extractable on shelves.</li> <li>7. No. 1 telescopic mast for max. height 8 m. with manual air for extension, complete with 4 removable spotlights;</li> <li>8. Grounding system with connection and rods.</li> <li>9. Operation: suitable for teams of 6-8 people working in full autonomy.</li> </ul> |
|---|---|

#### Prices: Ex-Works Gruaro - Italy

1. MOD. CON20-2GV-LAB-EV-10A (including the equipment above): **€uro/each.** \_\_\_\_\_ **+ VAT.-**

