



DATA SHEET 24.8



Front view



Internal view



Top view

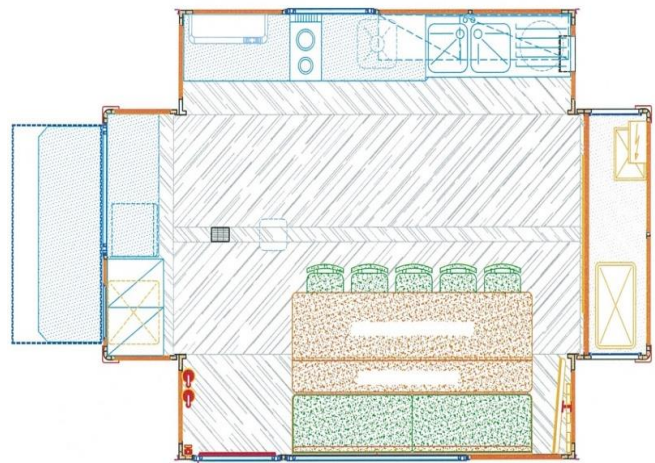

The plant in the operating position (Area 22,00 m²)

Multifunctional mobile operations unit with kitchen on expandable Iso 20ft Container

MOD. CON20A-2GV-PFMC-BV1

- | | |
|---|--|
| <p>a) Strong body consisting of welded aluminum profiles with corner blocks as per ISO 20'-1CC standard.</p> <p>b) Portability with ordinary vehicles, as well as the ones complying with the international standards (ship - train - container-holder trucks, etc.) or mounted on multi-lift saddle as by DIN 30722</p> <p>c) Colored vinyl flooring, glued and finished strongly, mounted on waterproof plywood, with hinged movable elements for "expansion/closure" of the volume.</p> <p>d) Glazing smooth isolated perfectly sealed internal and external panels with thickness of 40 mm in 1 mm double aluminum.</p> <p>e) N. 1 cable gland hole on the external wall for Tv antenna cable</p> <p>f) Removable side panels from the main body. They are self-supporting and equipped with fixtures and fittings.</p> <p>g) Aluminum profile windows with safety glazing and panic bar on the door.</p> <p>h) Staff side entrance; a window on a wall of the inlet side, in the high part of the same wall.</p> <p>i) Possibility to use on the vehicle and on the ground (con richiesta a parte di pedane e scalette esterne).</p> <p>j) Separate front and equipped compartment, with two lateral and vertical rolling gate.</p> <p>k) Rear head equipped for the distribution</p> <p>l) Back overhead panel with transport unit's lights</p> <p>m) Painting and finishing with a choice of custom features of easy identification.</p> <p>n) Size when "closed" length 6058 x width 2438 x height 2591 mm. (as per ISO 20'-1CC standard or other heights on request overall dimensions in "operation" mode length 6058 x width 4284 x height 2591 mm. - net 22,00 m²;</p> <p>o) Time of deployment for "operational ready" mode: about 1/2 hour, with trained personnel.</p> | <p>1. Power supply 230 V (120 V on request) from the external grid or generator.</p> <p>2. Electrical cabinets placed inside for external connection and guards in accordance with the applicable regulations.</p> <p>3. Lighting system inside/outside and sockets on the workstations and for the devices installed.</p> <p>4. Distribution system and shunt box data</p> <p>5. Derivation from the outside and internal distribution of water, even when there is an own tank and drains</p> <p>6. Arrangement of a module with the following technical equipment:</p> <ul style="list-style-type: none"> > 1 Table with drawers > 1 Kitchen with 2 electric induction plates - professional type > 1 Worktop > 1 Kitchen sink with 2 basins and lateral drainer and upper cupboard unit > 1 Internal top for distribution with underlying 1 door fridge 100 Lt > 1 external reclining top in inox for the distribution with support shelves > 1 column cupboard > 1 Rack 19"x9U-with connection to the distribution system in the header wall > 1 40" monitor mounted on revolving bracket on the wall and removable; > 1 partly foldable mess/meetings table with settle at the wall with 5 stackable chairs ; > 1 writable panel/whiteboard + 1 Roll-away projection screen ; > 1 mono-split heating and air conditioning system with remote control ; <p>7. No. 1 muted generator of 10000 W to be removable + maintenance battery kit</p> <p>8. N. 1 holder column for parabolic antenna incl. which can be secured to any of the corner blocks, as needed,</p> <p>9. Earthing system with rod and 2 extinguishers</p> |
|---|--|

Prices: Ex-Works Gruaro (VE) – Italy.

1. MOD. CON20A-2GV-PFMC-BV1 (including the equipment above):..... **€uro/each** _____ **+ VAT**
2. Excluding transportation system –Support saddle for handling multi-lift system as by DIN 30722 twist lock included: **€.** _____ **+ VAT.-**

