

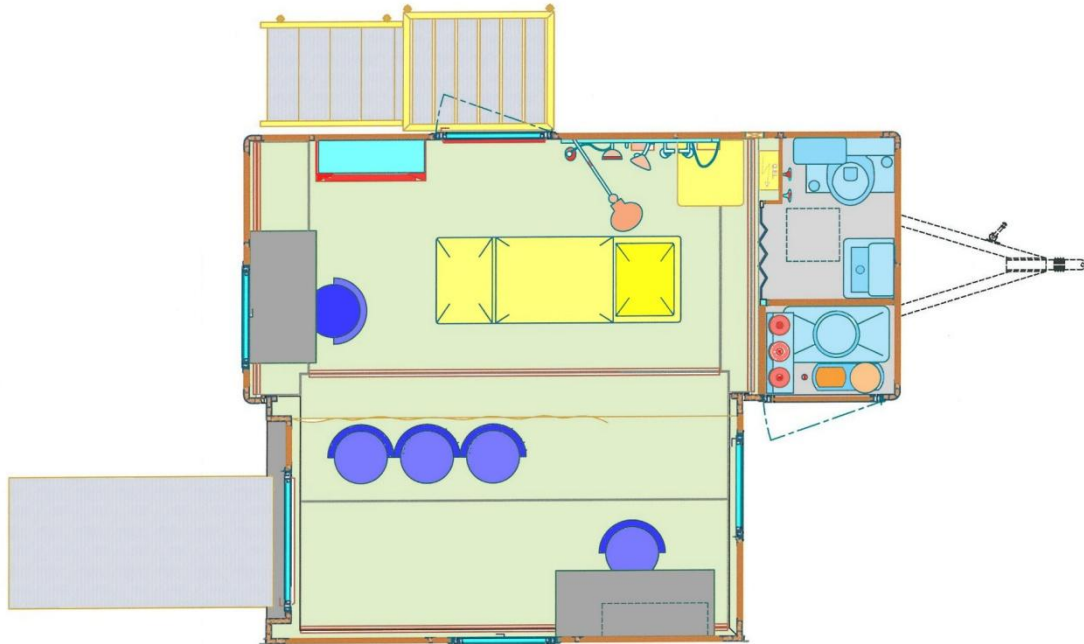

## DATA SHEET 21.2



Plan view of the unit



External view on expandable side of the unit



View of the unit in operation on the ground from the front



External view on the trailer of the unit

### Expandable Infirmary Unit on Trailer

#### MOD. CARINF5/2-GV-BS01

- |  |  |
|--|--|
| <ul style="list-style-type: none"> <li>a) Sturdy supporting structure with aluminium section bars obtained from press-formed 5754 alloy sheet, welded at the joints to form a self-supporting unit.</li> <li>b) Transportable by a trailer with a load capacity of 2500 Kg, or by standard vehicles with a loading platform large enough for the overall dimensions indicated below.</li> <li>c) Platforms and steps for several entrances from outside, detachable from the unit.</li> <li>d) Vinyl floor welded and glued onto waterproof, multi-layer wood support.</li> <li>e) Curtain walls with sandwich panels in double aluminium sheets coated with 40 mm polyurethane insulation.</li> <li>f) Partitions divide the technical compartment from the bathroom that can be accessed separately.</li> <li>g) Aluminium door and window frames with safety glass and panic bars on the back and staff entry doors.</li> <li>h) Side staff entrance, separate from the stretcher entrance and technical/service compartments.</li> <li>i) Can be used on board a vehicle or set on the ground.</li> <li>j) Side awning/veranda provides shelter over the side entrance.</li> <li>k) Custom paint and finishing work for higher visibility.</li> <li>l) Shelter size (in mm): length 5000 x width 2000 x height 2300 (as for trailer).</li> </ul> | <ul style="list-style-type: none"> <li>1. Electrical power supply from 220 V external source on external EEC socket.</li> <li>2. Internal electrical control panel for external branches and safety devices, in compliance with current regulations.</li> <li>3. Grounding system with connection and rods.</li> <li>4. Module equipment includes:             <ul style="list-style-type: none"> <li>&gt; <b>Technical compartment:</b> rack for oxygen bottles and water reserve tank.</li> <li>&gt; <b>Bathroom compartment:</b> includes washbasin, toilet and standard accessories.</li> <li>&gt; <b>Nursing Area with:</b> oxygen distribution network; bars that can be equipped; flow meter; vacuum aspirator; automatic resuscitation device; pressure gauge; first aid bed; stretchers and supports; scalytic lamp; sterilizer; IV stand; manual resuscitator; portable oxygen bottle.</li> </ul> </li> <li>5. Plumbing system with electric boiler and surge tank, connection to an external network, with external release.</li> <li>6. Stretcher access also possible on the external platform/ramp through wide 2-leaf back door.</li> <li>7. Service furniture in the freestanding unit includes: desk, chair, cupboard, sink, refrigerator.</li> <li>8. Rooftop summer/winter air-conditioning with interior control.</li> <li>9. Set-up time for "ready state": approx. 30 minutes with trained staff.</li> <li>10. trolley certified for standard "transportation of goods", 2 axles-hook sphere, with 2000/2500 Kg capacity.</li> </ul> |
|--|--|

#### Prices: Ex-Works Gruaro – Italy

1. MOD. CARINF5/2-GV-BS01 (including all equipment listed): ..... Euro/each \_\_\_\_\_ + V.A.T.-
2. TRAILER EXCLUDED

