

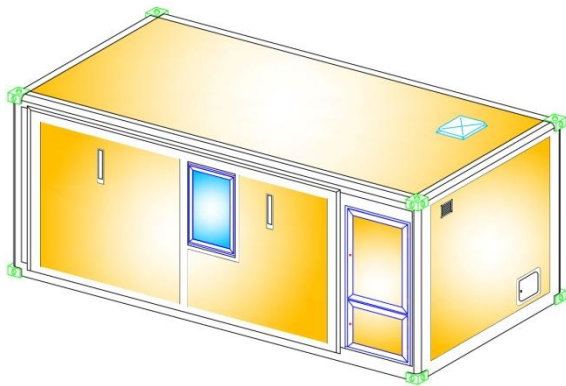

DATA SHEET 21.4

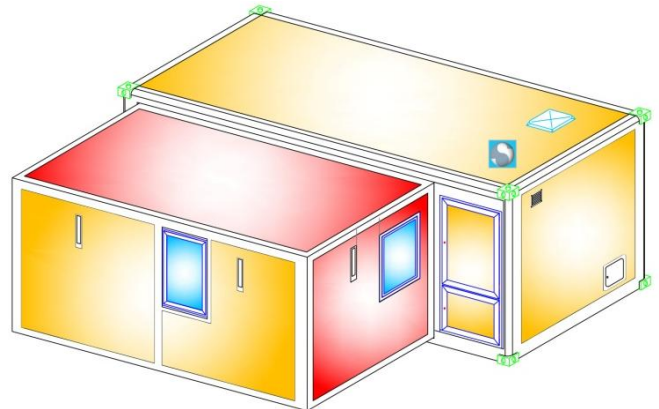

External view of the unit in transport mode (closed)



View of the unit in operational mode

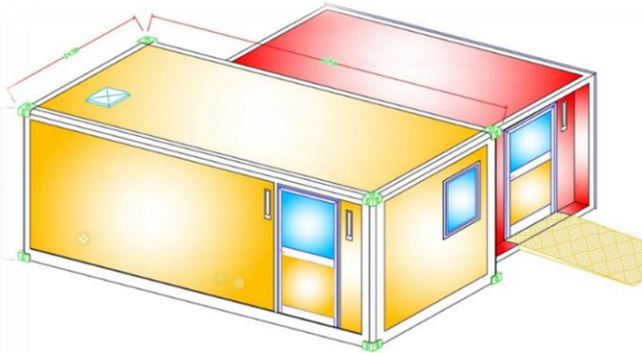

View of stretcher entrance side

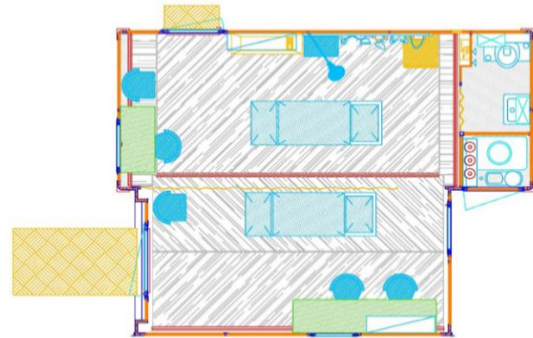

View/plan view of the unit in operational mode

Expandable medical container - Iso 20ft

MOD. CON20AL-1GV-INF/1

- a) Ideal size for transportation on trucks with ISO 20'1CC container platform.
- b) Sturdy supporting structure with aluminium extruded profiles and press-formed sheets (5754 alloy).
- c) 2 front compartments: 1) for service equipment and connections + compartment for emergency generator; 2) bathroom area with: 1 caravan type WC and basin.
- d) Single supporting body on telescopic sliding rails on the expandable side to obtain a double volume on the operating area.
- e) Easy and completely manual closing and opening system.
- f) Plastic material floor (rubber or vinyl) on waterproof multi-layer wood.
- g) External cladding with sandwich panels made from 40 mm polyurethane insulation panel in double painted aluminium 1 mm int/ext. sheets.
- h) Side staff entrance. Stretcher and user entrance on the expandable side, fitted with platform/ramp and possible awning application.
- i) Aluminium door and window frames with polycarbonate glass (or safety glass) and panic bars; windows shaded internally by blinds.
- j) Crane lifting on ISO corner fittings, or installed on dismantling frame for Multi-lift system as per standard DIN 30722.
- k) Exterior painted in colours available on the RAL catalogue (by choice).
- l) Sizes in mm and weight:
closed 6058 x 2438 x H 2591 (ISO 20'-1CC std) – open 6058 x 4596 x H 2591. Total weight: approx. 4500 Kg.-

- 1. Electrical power supply from 230 V external network on external EEC socket.
- 2. Internal electrical control panel for external branches and safety devices, in compliance with current regulations.
- 3. Grounding system with connection and rods.
- 4. Module equipment includes:
 - > **Technical compartment:** rack for oxygen bottles and water reserve tank.
 - > **Bathroom compartment:** includes washbasin, toilet and standard accessories.
 - > **Nursing Area with:** oxygen distribution network; bars that can be equipped; flow meter; vacuum aspirator; automatic resuscitation device; pressure gauge; first aid bed; stretchers and supports; scialytic lamp; sterilizer; IV stand; manual resuscitator; portable oxygen bottle.
- 5. Plumbing system with electric boiler and surge tank pump, connection to an external network, with external release.
- 6. Stretcher access also possible on the external platform/ramp through through a wide 2 leaf back door.
- 7. Service furniture includes: desk, chair, cupboard, sink, refrigerator.
- 8. Rooftop summer/winter air conditioning with interior control.
- 9. Set up time for "ready state": approx. 1 hour with trained staff.

Prices: Ex-Works Gruaro - Italy

1. **MOD. CON20AL-1GV-INF/1** (including basic equipment listed):.....**€uro/each** _____ **+ V.A.T-**

